

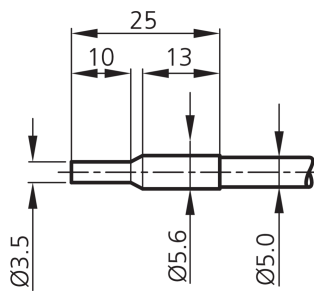

202085
WRB 220 P-5.6-2.5
Glass fiber optics

- High-quality glass fibers
- Resistant to high temperatures
- Robust, highly flexible



Technical data (typ.)		+20°C, 24 V DC	
Length		600 mm	
Dimension fiber bundle		Ø 2.5 mm	
Housing length		13 mm	
Light aperture		axial	
Mounting diameter		Ø 5.6 mm	
Bending radius		> 5 x tube-Ø	
Material of fiber		Glass fibers	
Material		<ul style="list-style-type: none"> ■ Stainless steel (Sensor probe) ■ PU sleeve (Coating) 	
Operating principle		Through-beam sensor	
Design		Cylinder	
Single fiber		Ø 0.05 mm	
To be used for		Amplifiers for glass fiber optics	
Opening angle		67°	
Scanning range		1000 mm	
Temperature resistance		-20 ... +90 °C (temporarily up to +120 °C)	
Protection type		IP 67	
More information / accessories		https://www.di-soric.com/202085	