

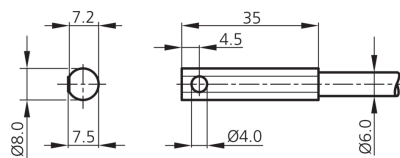

**202101**  
**WRB 220 SR-8.0-2.5**  
**Glass fiber optics**

- High-quality glass fibers
- Resistant to high temperatures
- Robust, highly flexible



Technical data (typ.)	+20°C, 24 V DC
Length	600 mm
Dimension fiber bundle	Ø 2.5 mm
Housing length	35 mm
Light aperture	radial
Mounting diameter	Ø 8 mm
Bending radius	> 3 x tube-Ø
Material of fiber	Glass fibers
Material	<ul style="list-style-type: none"> <li>■ Stainless steel (Sensor probe)</li> <li>■ Silicone-metal sleeve (Coating)</li> </ul>
Operating principle	Through-beam sensor
Design	Cylinder
Single fiber	Ø 0.05 mm
To be used for	Amplifiers for glass fiber optics
Opening angle	67°
Scanning range	800 mm
Temperature resistance	-40 ... +180 °C (temporarily up to +250 °C)
Protection type	IP 67
<b>More information / accessories</b>	<b><a href="https://www.di-soric.com/202101">https://www.di-soric.com/202101</a></b>