

202983

OLS 12 V 2000-IBSL

Laser through-beam sensor, transmitter

- Compact design
- Collimated red-light laser
- Visible laser spot
- Robust metal housing

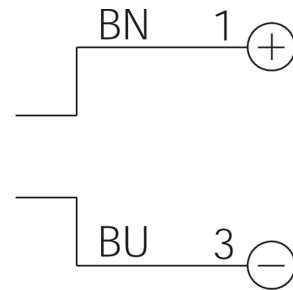
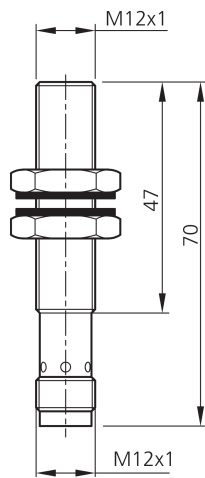
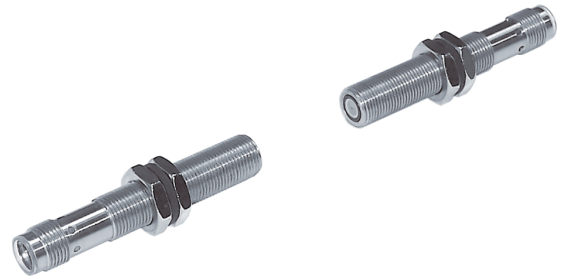

1) LED 4 x 90° (yellow)

BN: brown

BU: blue

**Function**



**Technical data (typ.)**

**+20°C, 24 V DC**

|                                      |  |
|--------------------------------------|--|
| Service voltage                      | 10 ... 35 V DC                           |
| No-load current (max.)               | 30 mA                                    |
| Insulation voltage endurance         | 500 V                                    |
| Thread                               | M12 x 1                                  |
| Housing material                     | Stainless steel                          |
| Protection class                     | III, operation on protective low voltage |
| Operating principle                  | Through-beam sensor                      |
| Evaluation                           | digital                                  |
| Design                               | Thread                                   |
| Consisting of                        | Transmitter                              |
| Light source                         | Laser                                    |
| Laser class                          | 1 (IEC 60825-1)                          |
| Color                                | red                                      |
| Wavelength                           | 670 nm                                   |
| Modulation                           | Clocked                                  |
| Laser beam divergence                | 2 mrad                                   |
| Range                                | 0 ... 2000 mm                            |
| Sensitivity adjustment               | no setting elements                      |
| Switching frequency                  | 2000 Hz                                  |
| Ambient temperature during operation | 0 ... +50 °C                             |



202983

OLS 12 V 2000-IBSL

Laser through-beam sensor, transmitter

**Technical data (typ.)**

**+20°C, 24 V DC**

Protection type

IP 67

Connection

Connector, M12, 4-pin

Connection cable

VK ...

**More information / accessories**

<https://www.di-soric.com/202983>