

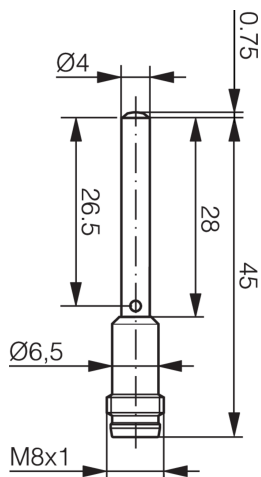

213032
OTD04-10PS-T3
Retroreflective diffuse sensor

- Extremely small design
- Red light
- Scanning range preset
- Stainless steel housing
- Can be installed countersunk
- Large temperature range



BK: black BN: brown BU: blue

Function



Technical data (typ.)

+20°C, 24 V DC

Service voltage	10 ... 30 V DC
No-load current (max.)	15 mA
Inverse polarity protection	Yes
Diameter	Ø 4.0 mm (Diameter)
Housing length	45.8 mm
Housing material	Stainless steel (V2A)
Material	Plastic (Window / optics)
Weight	4 g
Protection class	III, operation on protective low voltage
Operating principle	Retroreflective diffuse sensor
Evaluation	digital
Design	Cylinder
Switching output	pnp, 100 mA, NO
Voltage drop (max.)	2 V
Light source	LED
Color	Red
Wavelength	630 nm
Light spot size	5 x 6 mm (at distance of 10 mm)
Scanning range	10 mm
Standardized measuring plate	200 x 200 mm (white)

**213032****OTD04-10PS-T3****Retroreflective diffuse sensor****Technical data (typ.)****+20°C, 24 V DC**

Sensitivity adjustment

no setting elements

Switching frequency

1000 Hz

Ambient temperature during operation

-25 ... +65 °C

Protection type

IP 67

Connection

Connector, M8, 3-pin

More information / accessories<https://www.di-soric.com/213032>