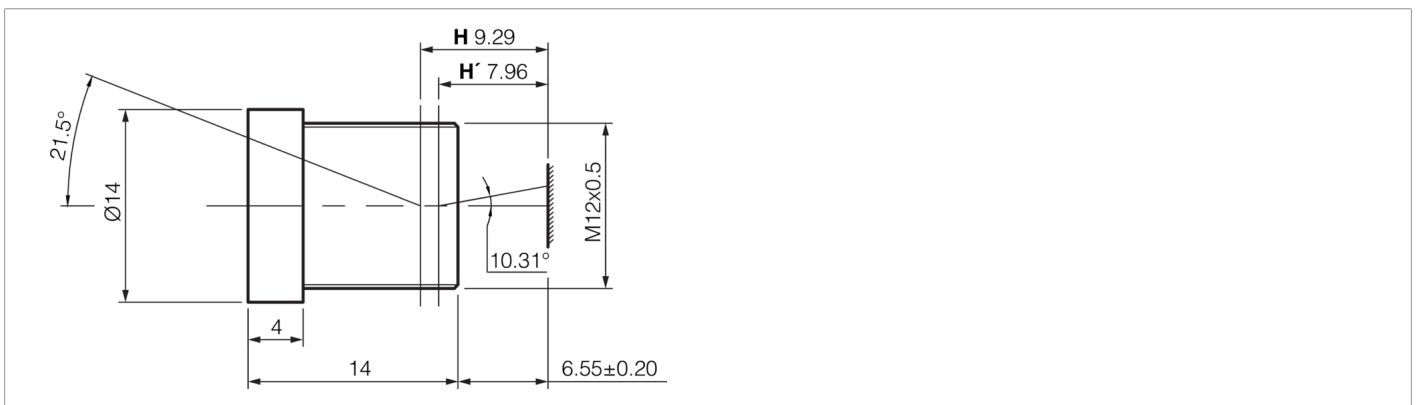

- IR-cut filter coating
- Light shutter
- High resolution
- Robust design

**Technical data (typ.)**
**+20°C**

Length	14 mm
Diameter	Ø 14 mm (Diameter)
Lens connection	S-mount
Filter thread	M12 x 0.5
Weight	6 g
Wavelength	400 ... 950 nm
Focal length	8 mm
Aperture (F)	4.0
First principal plane	9.29 mm
Second principal plane	7.96 mm
Angle of view (object)	21.5°
Angle of view (image)	10.31°
Aperture type	Fixed
Sensor size	1/3"
Resolution	1 Megapixel
Working distance	endless
Temperature resistance	-20 ... +65 °C

**More information / accessories**
<https://www.di-soric.com/213096>