

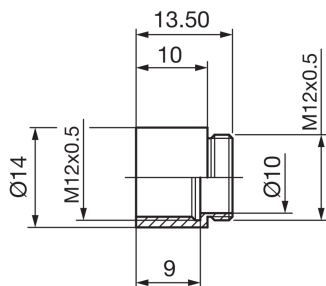

- For adjusting the working distance of lenses
- Robust design
- Easy to install



#### Technical data (typ.)

Housing material	Aluminum (Black, Anodized)
Lens connection	S-mount
Component	Spacer ring
To be used for	Vision Systems and ID Systems
Scope of delivery	1 pieces
Spacer distance (mm)	10.0 mm

#### More information / accessories

<https://www.di-soric.com/214260>