

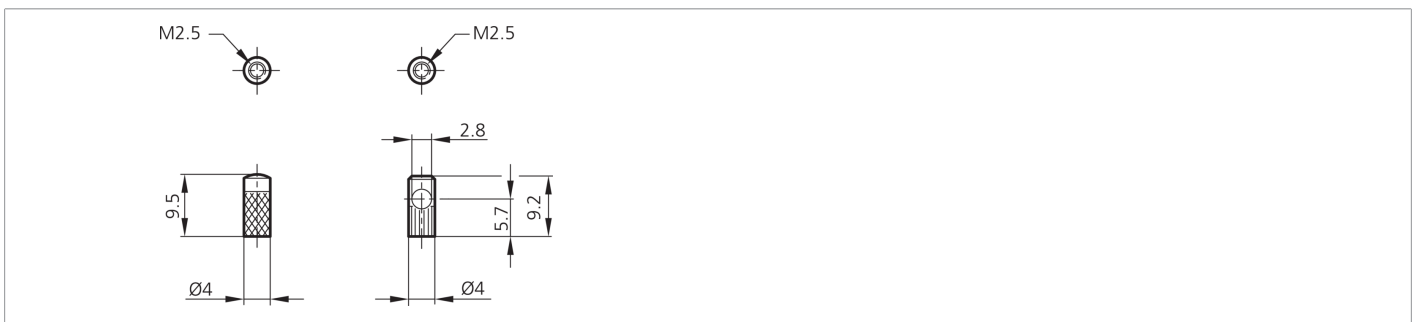

201883
VO M 2.5-90°
Attachment optics

- Metal casing
- To deflect the beam, it is mounted on the transmitter probe.



| Technical data (typ.) | | +20°C |
|--------------------------------------|--|---|
| Thread | | M2.5 |
| Light aperture | | radial |
| Housing material | | Metal |
| Component | | Attachment optics |
| To be used for | | Plastic fiber optics |
| Ambient temperature during operation | | -40 ... +70 °C |
| More information / accessories | | https://www.di-soric.com/201883 |