

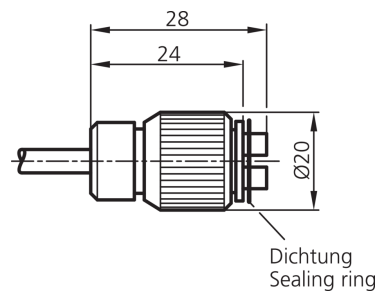

**202022**  
**WRB 130 MR-8.0-2.5**  
**Glass fiber optics**

- High-quality glass fibers
- Resistant to high temperatures
- Robust, highly flexible

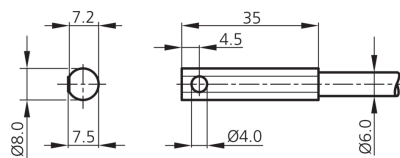

Technical data (typ.)		+20°C, 24 V DC
Length		1,000 mm
Dimension fiber bundle		Ø 2.5 mm
Housing length		35 mm
Light aperture		radial
Mounting diameter		Ø 7.5 mm
Bending radius		> 10 x tube-Ø
Material of fiber		Glass fibers
Material		<ul style="list-style-type: none"> <li>■ Stainless steel (Sensor probe)</li> <li>■ metal sleeve (Coating)</li> </ul>
Operating principle		Diffuse sensor
Design		Cylinder
Single fiber		Ø 0.05 mm
To be used for		Amplifiers for glass fiber optics
Opening angle		67°
Scanning range		70 mm
Temperature resistance		-40 ... +180 °C (temporarily up to +300 °C)
Protection type		IP 60
More information / accessories		<a href="https://www.di-soric.com/202022">https://www.di-soric.com/202022</a>