

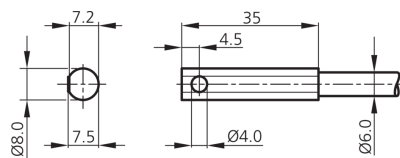

202052
WRB 210 MR-8.0-2.5
Glass fiber optics

- High-quality glass fibers
- Resistant to high temperatures
- Robust, highly flexible



Technical data (typ.)		+20°C, 24 V DC	
Length		300 mm	
Dimension fiber bundle		Ø 2.5 mm	
Housing length		35 mm	
Light aperture		radial	
Mounting diameter		Ø 8 mm	
Bending radius		> 10 x tube-Ø	
Material of fiber		Glass fibers	
Material		<ul style="list-style-type: none"> ■ Stainless steel (Sensor probe) ■ metal sleeve (Coating) 	
Operating principle		Through-beam sensor	
Design		Cylinder	
Single fiber		Ø 0.05 mm	
To be used for		Amplifiers for glass fiber optics	
Opening angle		67°	
Scanning range		800 mm	
Temperature resistance		-40 ... +180 °C (temporarily up to +300 °C)	
Protection type		IP 60	
More information / accessories		https://www.di-soric.com/202052	