



202059

WRB 210 S-90-4.0-2.5

Glass fiber optics

- High-quality glass fibers
- Resistant to high temperatures
- Robust, highly flexible

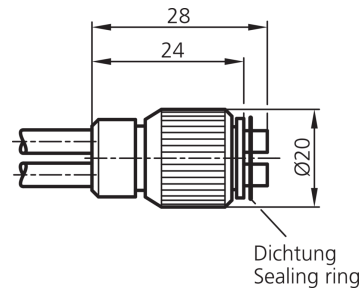
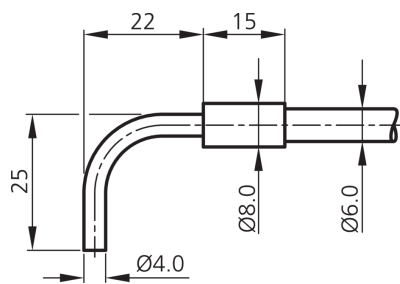

Technical data (typ.)

Length	300 mm
Dimension fiber bundle	Ø 2.5 mm
Housing length	15 mm
Light aperture	radial
Mounting diameter	Ø 8 mm
Bending radius	> 3 x tube-Ø
Material of fiber	Glass fibers
Material	<ul style="list-style-type: none"> ■ Stainless steel (Sensor probe) ■ Silicone-metal sleeve (Coating)
Operating principle	Through-beam sensor
Design	Cylinder
Single fiber	Ø 0.05 mm
To be used for	Amplifiers for glass fiber optics
Opening angle	67°
Scanning range	900 mm
Temperature resistance	-40 ... +180 °C (temporarily up to +250 °C)
Protection type	IP 67

More information / accessories

<https://www.di-soric.com/202059>