

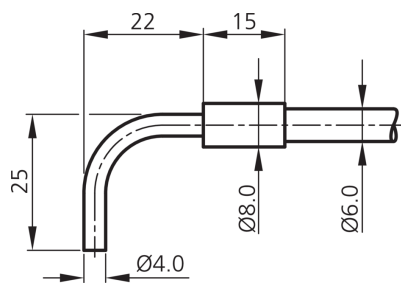

**202076**  
**WRB 220 M-90-4.0-2.5**  
**Glass fiber optics**

- High-quality glass fibers
- Resistant to high temperatures
- Robust, highly flexible



Technical data (typ.)		+20°C, 24 V DC	
Length		600 mm	
Dimension fiber bundle		Ø 2.5 mm	
Housing length		15 mm	
Light aperture		radial	
Mounting diameter		Ø 8 mm	
Bending radius		> 10 x tube-Ø	
Material of fiber		Glass fibers	
Material		<ul style="list-style-type: none"> <li>■ Stainless steel (Sensor probe)</li> <li>■ metal sleeve (Coating)</li> </ul>	
Operating principle		Through-beam sensor	
Design		Cylinder	
Single fiber		Ø 0.05 mm	
To be used for		Amplifiers for glass fiber optics	
Opening angle		67°	
Scanning range		900 mm	
Temperature resistance		-40 ... +180 °C (temporarily up to +300 °C)	
Protection type		IP 60	
<b>More information / accessories</b>		<a href="https://www.di-soric.com/202076">https://www.di-soric.com/202076</a>	