

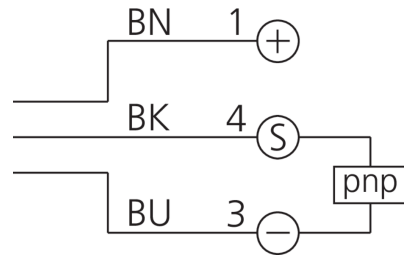

**202847**  
**OLE 12 V 2000 P2K-IBSL**  
**Laser through-beam sensor, receiver**

- Compact design
- High resolution, switching accuracy, switching frequency
- Robust metal housing

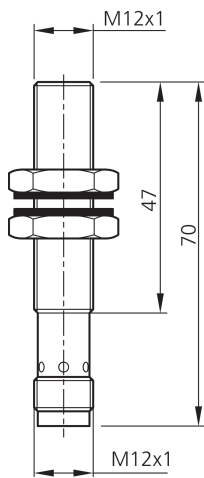
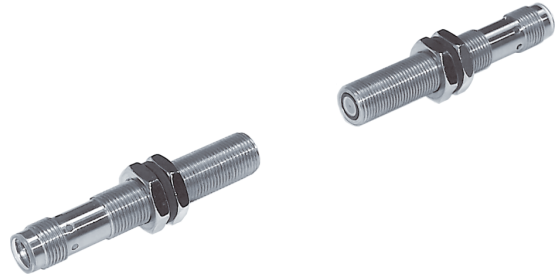

1) LED 4 x 90° (yellow)

BK: black

BN: brown

BU: blue

**Function**



**Technical data (typ.)**

**+20°C, 24 V DC**

Service voltage	10 ... 35 V DC
No-load current (max.)	30 mA
Insulation voltage endurance	500 V
Thread	M12 x 1
Housing material	Stainless steel
Protection class	III, operation on protective low voltage
Operating principle	Through-beam sensor
Evaluation	digital
Design	Thread
Consisting of	Receiver
Switching output	pnp, 200 mA, NO
Voltage drop (max.)	2.5 V
Light source	Laser
Ambient light immunity	5 kLx
Range	0 ... 2000 mm
Resolution	Ø 0.5 mm
Switching hysteresis (max.)	0.1 mm
Reproducibility	< 0.1 mm
Sensitivity adjustment	no setting elements
Switching frequency	2000 Hz



**202847**

**OLE 12 V 2000 P2K-IBSL**

**Laser through-beam sensor, receiver**

**Technical data (typ.)**

**+20°C, 24 V DC**

Ambient temperature during operation

0 ... +50 °C

Protection type

IP 67

Connection

Connector, M12, 4-pin

Connection cable

VK ...

**More information / accessories**

<https://www.di-soric.com/202847>