

- IR-cut filter coating
- Light shutter
- High resolution
- Robust design

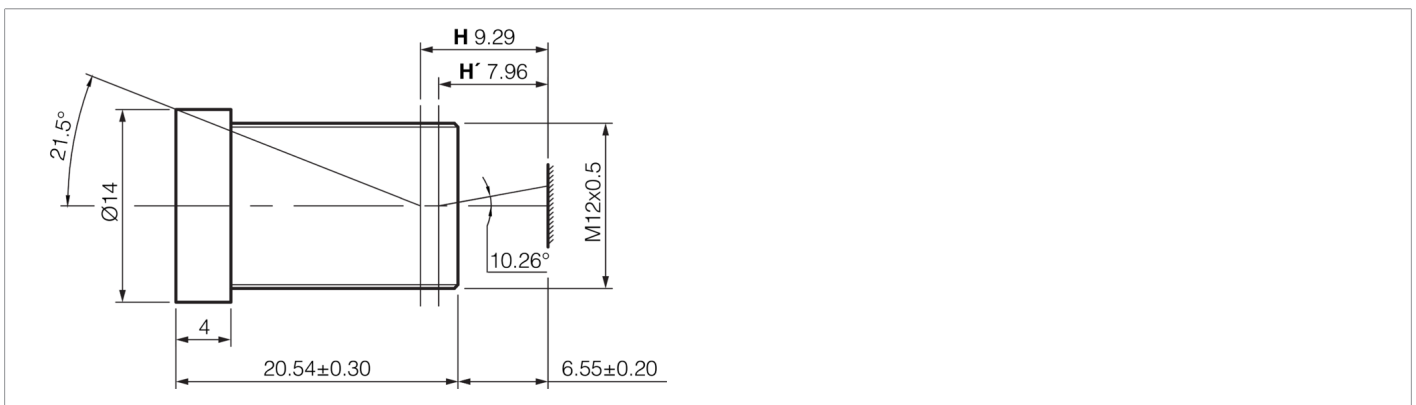

Technical data (typ.)	+20°C
Length	20.54 mm
Diameter	$\varnothing 14$ mm (Diameter)
Lens connection	S-mount
Filter thread	M12 x 0.5
Weight	6 g
Wavelength	400 ... 950 nm
Focal length	8 mm
Aperture (F)	4.0
First principal plane	9.29 mm
Second principal plane	7.96 mm
Angle of view (object)	$21.5^\circ$
Angle of view (image)	$10.26^\circ$
Aperture type	Fixed
Sensor size	1/3"
Resolution	1 Megapixel
Working distance	endless
Temperature resistance	-20 ... +65 °C
<b>More information / accessories</b>	<a href="https://www.di-soric.com/213096">https://www.di-soric.com/213096</a>